

**KEY NOTES**

- ① ACI- WALL MOUNTED HEAT PUMP NOMINAL 41,500 BTUH COOL/41,000 BTUH HEAT W/ 5kw HEATER O. L. A. & CALIFORNIA STATE ENERGY APPROVED - 1400 CFM-200/230v 1 PHASE MAX F.L.A. 28 AMPS -WT.510lbs - 3 1/2 TON
- ② ① THERMOSTAT- WHITE ROGERS 1F72-71 MOUNT C-4B AFF
- ③ NOT USED
- ④ FLEX DUCT
- ⑤  15X15 4W SUPPLY AIR GRILLE
- ⑥ 10" x 30" X 2' PLENUM

IDENTIFICATION STAMP  
DIV. OF THE STATE ARCHITECT  
OFFICE OF REGULATION SERVICES  
04 10 15 00  
AC *[Signature]*  
DATE SEP 09 1999

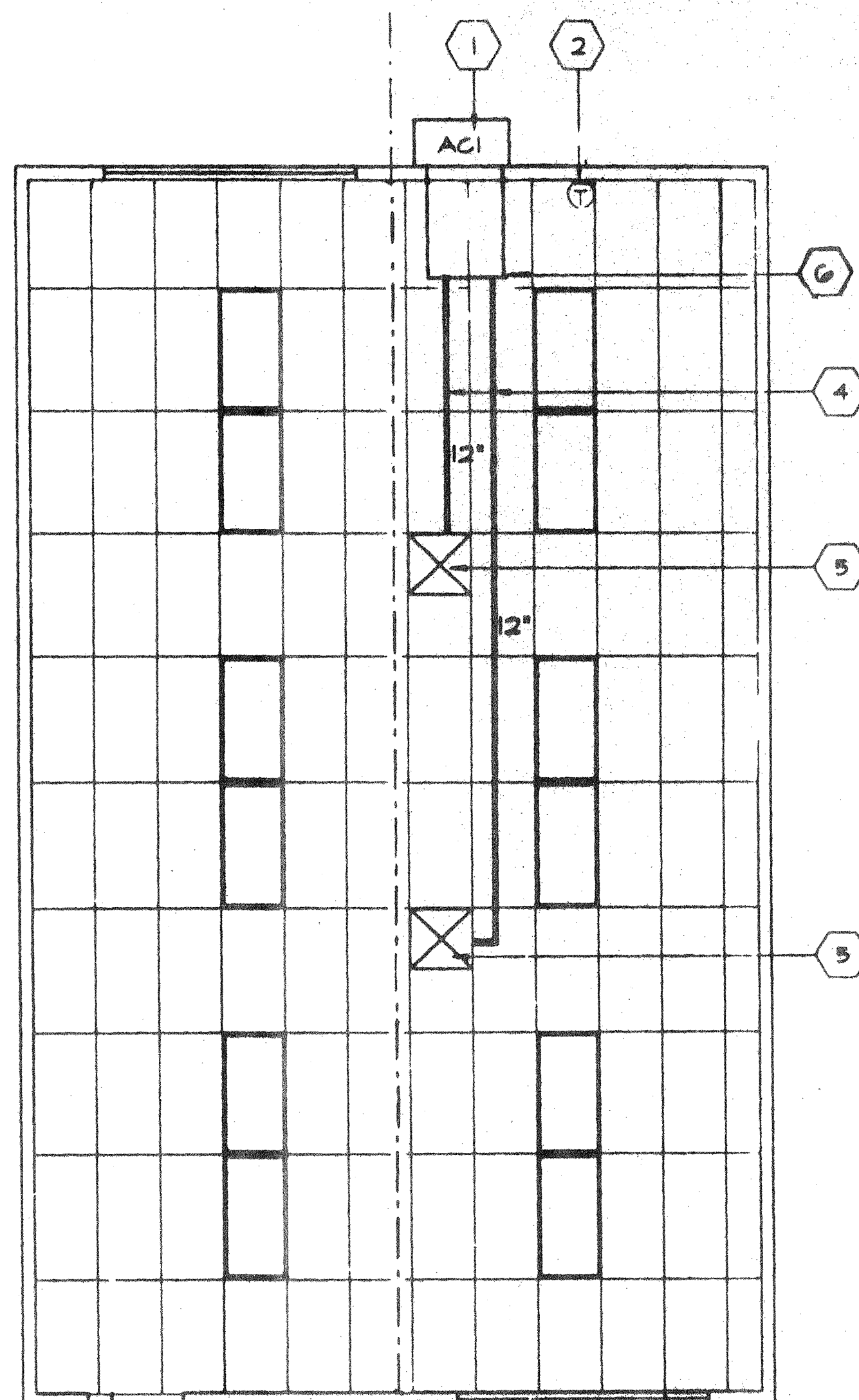

"A" SHOWN  
"B" OPPOSITE

**SCHOOL EQUIPMENT ANCHORAGE**

THE FOLLOWING IS FOR THE MECHANICAL ENGINEER'S INFORMATION ONLY

THE SEISMIC ANCHORAGE OF MECHANICAL EQUIPMENT SHALL CONFORM TO C.C.R. TITLE 24, SECTION 2912 (b) AND TABLE 25-F ANCHORAGE DETAILS FOR ROOF/FLOOR MOUNTED EQUIPMENT WEIGHING LESS THAN 400 LBS AND HUNG EQUIPMENT WEIGHING LESS THAN 20 LBS MAY BE OMITTED FROM THE PLANS

**FOR MECHANICAL DRAWINGS:**

ALL MECHANICAL EQUIPMENT SHALL BE BRACED OR ANCHORED TO RESIST A HORIZONTAL FORCE ACTING IN ANY DIRECTION USING THE FOLLOWING CRITERIA:

EQUIPMENT ON GRADE	30% OF OPERATING HEIGHT
EQUIPMENT ON STRUCTURE	50% OF OPERATING HEIGHT

FOR FLEXIBLY MOUNTED EQUIPMENT USE 4 X THE ABOVE VALUES, AND FOR SIMULTANEOUS VERTICAL FORCE USE 1/3 X THE HORIZONTAL FORCE

THE ABOVE VALUES ARE FOR AN IMPORTANCE FACTOR, I = 1.0 AND SEISMIC ZONE, Z = 0.4

WHERE ANCHORAGE DETAILS ARE NOT SHOWN ON THE DRAWINGS THE FIELD INSTALLATION SHALL BE SUBJECT TO THE APPROVAL OF THE MECHANICAL ENGR AND THE FIELD ENGINEER OF THE OFFICE OF THE STATE ARCHITECT

AGENCY TRACKING NO. 63321-201  
FILE NO. 15-6

IDENTIFICATION STAMP  
DIV. OF THE STATE ARCHITECT  
OFFICE OF REGULATION SERVICES  
03-117283  
AC *[Signature]* FLS *[Signature]* SS *[Signature]* PCL  
DATE SEP 13 2018

**MECH. (HVAC) PLAN**

SCALE 1/4"=1'-0"

**CONTROL SCHEMATIC**

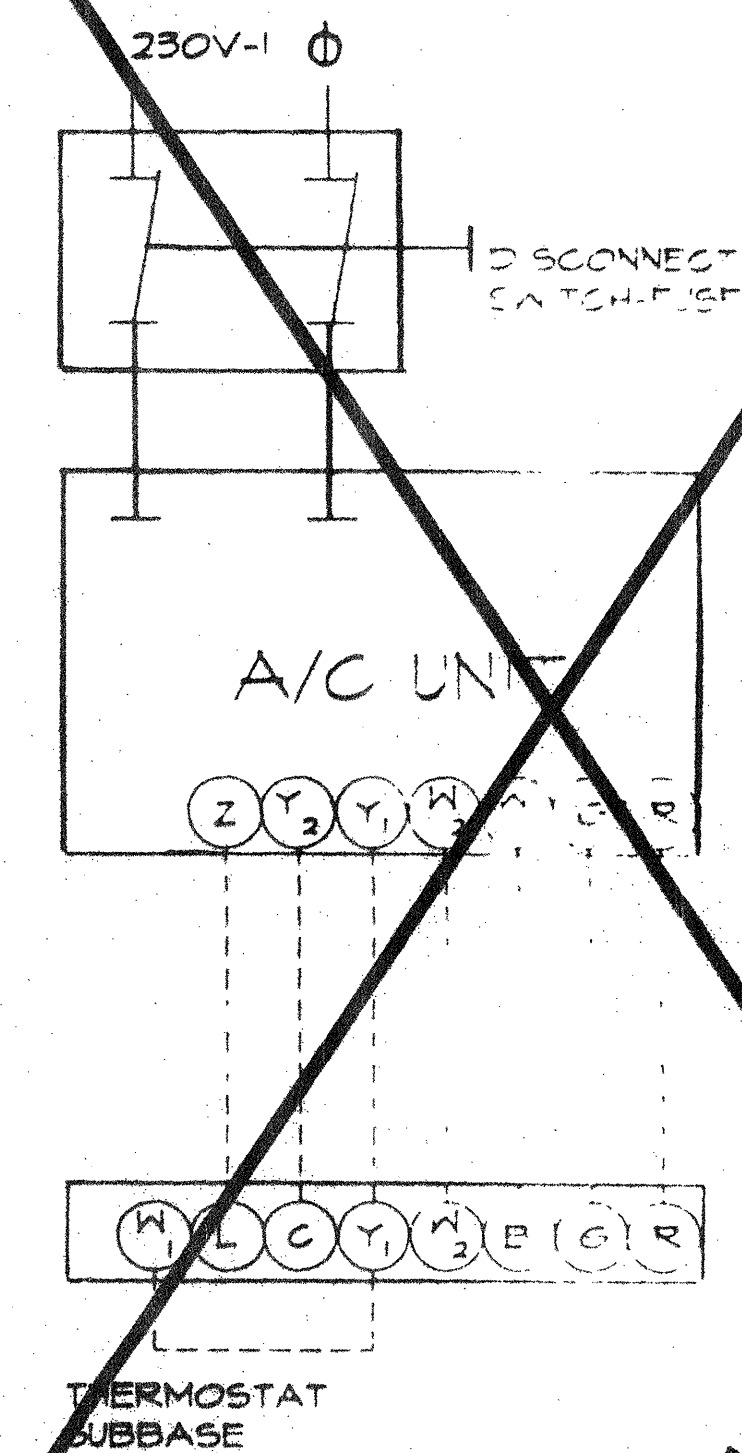

4012-09A

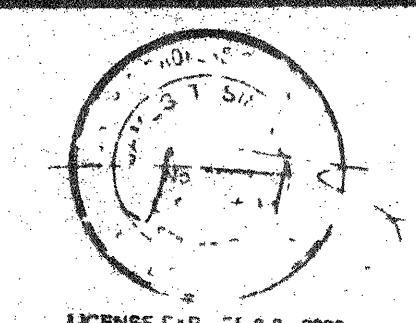
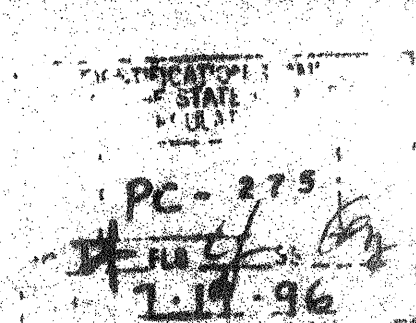
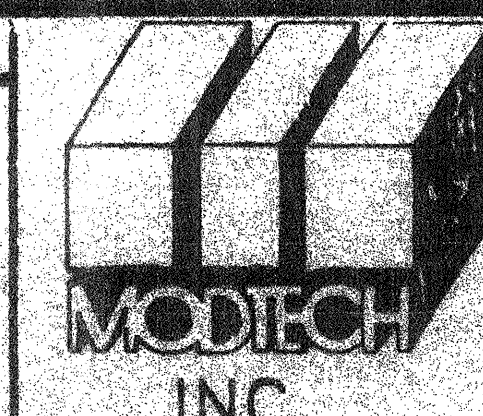
ARCHITECT 	ELECTRICAL	STRUCTURAL 	MECHANICAL	FIRE MARSHAL	ACCESS COMPLIANCE	STRUCTURAL SAFETY 	3270	DATE 9/9/99	M1.0
							MECH (HVAC) PLAN		