

**SITE PLAN**  
**PIONEER ELEMENTARY SCHOOL**

SCALE: 1" = 40'

**KEY NOTES**

1. EXISTING FIRE HYDRANT TO REMAIN
2. EXISTING CHAIN LINK FENCE TO REMAIN
3. EXISTING PARKING LOT AND STRIPING TO REMAIN
4. EXISTING BUILDING TO REMAIN (NO WORK)
5. EXISTING PLAY AREA TO REMAIN (NO WORK)
6. EXISTING A.C. PAVING TO REMAIN
7. EXISTING LAWN / TURF TO REMAIN
8. EXISTING CONCRETE WALK TO REMAIN
9. EXISTING 20' WIDE FIRE TRUCK ACCESS LANE TO REMAIN
10. EXISTING SITE ENTRANCE SIGN PER DSA APP #03-113549
11. EXISTING ACCESSIBLE RAMP & HANDRAILS PER DSA APP #03-113549

**ACCESSIBILITY NOTES**

ARCHITECT HAS INSPECTED THE PATH OF TRAVEL (P.O.T.) AS INDICATED ON THE PLANS AND HAS FOUND IT TO BE, OR HAS INDICATED ON THE PLANS REMEDIAL WORK WHICH WOULD CAUSE IT TO BE, A BARRIER-FREE ACCESSIBLE ROUTE:

- AT LEAST 48" IN WIDTH; OR AS APPROVED BY CODE
- FREE OF ABRUPT LEVEL CHANGES EXCEEDING 1/2" IF BEVELED AT 1:2 MAX SLOPE, OR VERTICAL LEVEL CHANGES EXCEEDING 1/4"
- WITH A FIRM, STABLE, AND SLIP RESISTANT WALKING SURFACE
- WITH A RUNNING SLOPE OF 1:20 (5%) OR LESS AND WITH A CROSS SLOPE OF 1:50 (2%) OR LESS OR A RAMP WITH A RUNNING SLOPE OF 1:12 (8.33%) AND A CROSS SLOPE OF 1:50 (2%) WITH APPROPRIATE REQUIREMENTS AS DETAILED WITHIN THIS SET OF DOCUMENTS.
- IS FREE OF OVERHEAD OBSTRUCTIONS WITHIN 80" ABOVE THE WALKING SURFACE
- IS FREE OF OBJECTS WHICH PROTRUDE MORE THAN 4" BETWEEN THE HEIGHTS OF 27" AND 80" ABOVE THE WALKING SURFACE

**LEGEND**

- INDICATES EXISTING BUILDING TO REMAIN (NO WORK)
- INDICATES (E) FIRE TRUCK ACCESS OVER AC PAVING
- DASHED LINE INDICATES (E) ACCESSIBLE PATH OF TRAVEL

**DSA** APPROVED  
 DIV. OF THE STATE ARCHITECT  
 LOS ANGELES REGIONAL OFFICE

SS - TN FLS N/A AC - SC  
 DATE 8/6/2015 (A#03-115335)

REF. DWG. "A-101"

**Ownership of Documents**  
 This document, the ideas and designs incorporated herein, as an instrument of Professional Service is the property of Integrated Designs by SOMAM Inc. and is not to be used, in whole or in part for any other project without written authorization.  
 © COPYRIGHT 2014

**integrated designs** by SOMAM, Inc.  
 ARCHITECTURE · ENGINEERING · INTERIOR DESIGN · CONSTRUCTION MANAGEMENT  
 6011 N. Fresno, Suite 130 - Fresno, California 93710  
 Phone (559) 438-0881 Fax (559) 438-0887 E-Mail: design@somam.com  
 www.integrateddesigns.com

Revision	Revision Description	Rev. Date
1	CCD #2	7/10/15

**SITE PLAN**

**ACCESSIBLE ENTRY RAMP**  
**PIONEER ELEMENTARY SCHOOL**  
 BAKERSFIELD CITY SCHOOL DISTRICT  
 4404 PIONEER DRIVE BAKERSFIELD, CA 93306

Issue Date: 07/10/15  
 Date: 07/10/15  
 Designer: JMF  
 DR: JMF  
 PC: JMF

Agency Approval Stamp:

Stamp(s):

**5175**

Sheet No.: **X-A1**

Release: -CCD #2

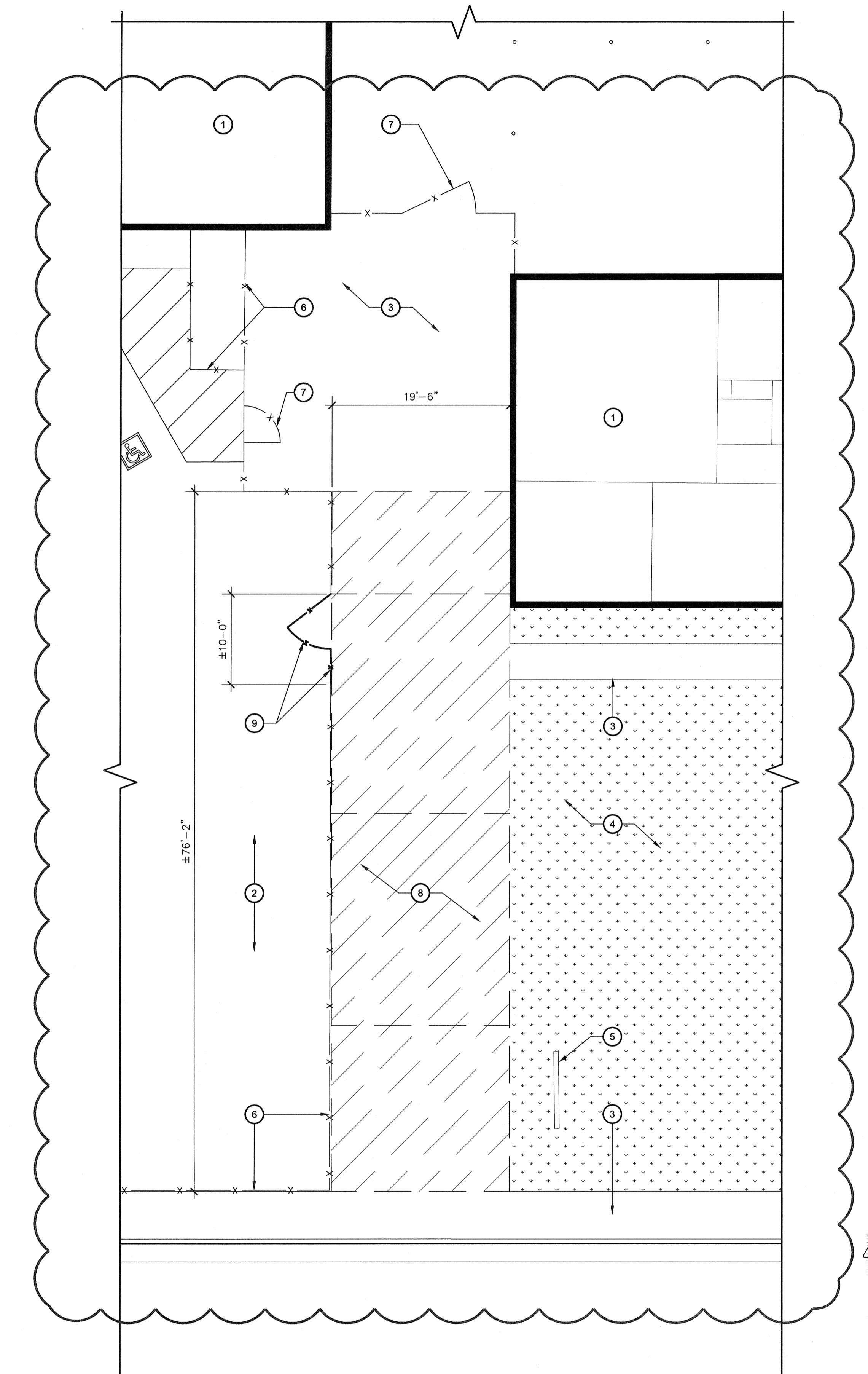
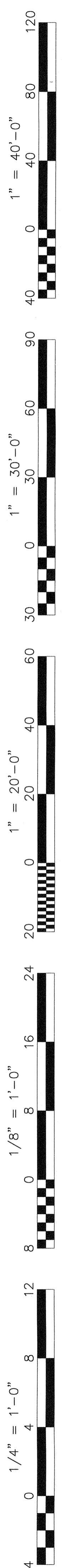

**DEMOLITION SITE PLAN**

SCALE: 1/8" = 1'-0"

**KEY NOTES**

1. (E) BUILDING TO REMAIN, NO WORK
2. (E) AC PAVING TO REMAIN
3. (E) CONCRETE WALK TO REMAIN
4. (E) LANDSCAPE AREA TO REMAIN
5. (E) MARQUEE SIGN TO REMAIN
6. (E) +3'-0" HIGH CHAIN LINK FENCE TO REMAIN
7. (E) ACCESSIBLE GATE PER DSA #R03-113549 TO REMAIN
8. REMOVE (E) CONCRETE WALK
9. REMOVE (E) CHAIN LINK GATE, GATE POST & PORTION OF FENCE AS REQ'D FOR NEW WORK
10. NEW 4'-0" WIDE CHAIN LINK GATE & FENCING INFILL, SEE 12X-A3
11. NEW 4'-0" WIDE x 3'-0" DEEP TRUNCATED DOMES SEE 11X-A3
12. +3'-0" HIGH, 1-1/2" Ø STD PIPE (1.9" O.D.) GALVANIZED HANDRAILS, TYPICAL SEE 10X-A3
13. 2% MAX SLOPE IN BOTH DIRECTIONS AT RAMP LANDINGS, TYP
14. NEW POST-MOUNTED DIRECTIONAL SIGN, SEE 13X-A3

**GENERAL NOTES**

- A. GENERAL CONTRACTOR SHALL FIELD VERIFY ALL SITE CONDITIONS PRIOR TO BID. IF ANY DISCREPANCIES ARE FOUND, THE ARCHITECT SHALL BE NOTIFIED IN WRITING.
- B. CONTRACTOR SHALL BE RESPONSIBLE FOR THE CORRECTNESS OF LAYOUTS AND ESTABLISHED LOCATIONS OF BURIED UTILITY LINES. ANY UTILITIES REQUIRING RELOCATION SHALL BE THE RESPONSIBILITY OF THE GENERAL CONTRACTOR CONTACT APPLICABLE GOVERNING AGENCIES REGARDING ARRANGEMENT AND COORDINATION OF WORK.
- C. GENERAL CONTRACTOR WILL BE RESPONSIBLE FOR ANY COMPACTION RETEST DUE TO INITIAL FAILURE.
- D. PROJECT INSPECTOR SHALL BE EMPLOYED BY THE OWNER, APPROVED BY THE RESPONSIBLE ARCHITECT AND DSA.
- E. A COPY OF TITLE-24, ALL PARTS APPLICABLE, TO BE KEPT AT THE JOB SITE AT ALL TIMES.
- F. ADDENDA SHALL BE SIGNED BY THE ARCHITECT (RESPONSIBLE IN CHARGE) AND APPROVED BY DSA.
- G. C.C.D.s SHALL BE SIGNED BY THE ARCHITECT (RESPONSIBLE IN CHARGE), OWNER AND APPROVED BY DSA.
- H. TESTING LAB SHALL BE EMPLOYED BY THE OWNER, APPROVED BY THE RESPONSIBLE ARCHITECT AND DSA.
- I. ALL WORK SURFACES DISTURBED OR DAMAGED BY THE CONSTRUCTION ACTIVITIES SHALL BE REPAIRED IN KIND, TEXTURED AND FINISHED TO MATCH ADJACENT SURFACES.
- J. NEW CONCRETE WALKS SHALL HAVE SLOPES NOT TO EXCEED 1 IN 20 IN THE DIRECTION OF PATH OF TRAVEL. PROVIDE CONTROL JOINTS ("C.J.") AT 5'0" o.c. MAX. AND EXPANSION JOINTS NOT TO EXCEED 30'-0" MAX. PROVIDE MEDIUM BROOM FINISH ON ALL WALKS.
- K. GENERAL/SITE CONTRACTOR SHALL FIELD VERIFY THAT EXISTING PATH OF TRAVEL (P.O.T.) IS A MINIMUM OF 4'-0" WIDE AND IS SLIP RESISTANT. IF IT IS NOT, THEN THE CONTRACTOR SHALL NOTIFY THE ARCHITECT OF RECORD AND A REMEDY OR ALTERNATE P.O.T. WILL BE PROVIDED.
- L. THE MAXIMUM DROP BETWEEN EXISTING FINISHED GRADES AND THE TOP OF THE P.O.T. SHOULD NOT EXCEED 4". IF IT DOES, PROVIDE THE NECESSARY WARNING CURB PER CBC SEC. 11B-303.5.

**LEGEND**

- (E) CONCRETE WALK TO BE REMOVED
- (E) LANDSCAPE AREA TO REMAIN, PROTECT FROM DAMAGE
- NEW CONCRETE WALK, SEE DETAILS 21X-A3 & 31X-A3
- DASHED LINE INDICATES ACCESSIBLE PATH OF TRAVEL

APPROVED  
 DIV. OF THE STATE ARCHITECT  
 LOS ANGELES REGIONAL OFFICE  
 SS -TN FLS N/A AC -SC  
 DATE 8/6/2015 (A#03-115335)

**Ownership of Documents**  
 This document, the ideas and designs incorporated herein, as an instrument of Professional Service is the property of Integrated Designs by SOMAM, Inc. and is not to be used, in whole or in part for any other project without written authorization.  
 © COPYRIGHT 2014

**integrated designs by SOMAM, Inc.**  
 ARCHITECTURE - ENGINEERING - INTERIOR DESIGN - CONSTRUCTION MANAGEMENT  
 5011 N. Fresno, Suite 100 Fresno, California 93710  
 Phone (559) 438-0681 Fax (559) 438-0687 E-Mail: design@somam.com  
 www.integrateddesigns.com www.fgprodesigns.com

Revision	Revision Description	Rev. Date
1		7/10/15

CCD #2

**ENLARGED SITE PLANS**

Project Name & Address:  
**ACCESSIBLE ENTRY RAMP**  
**PIONEER ELEMENTARY SCHOOL**  
 BAKERSFIELD CITY SCHOOL DISTRICT  
 4404 PIONEER DRIVE BAKERSFIELD, CA 93306

Issue Date:	07/29/15
Date:	07/29/15
Designer:	
DR:	
PC:	JMF

Agency Approval Stamp:

Stamp(s):

Job No.: **5175**

Sheet No.: **X-A2**

Release: -CCD #2

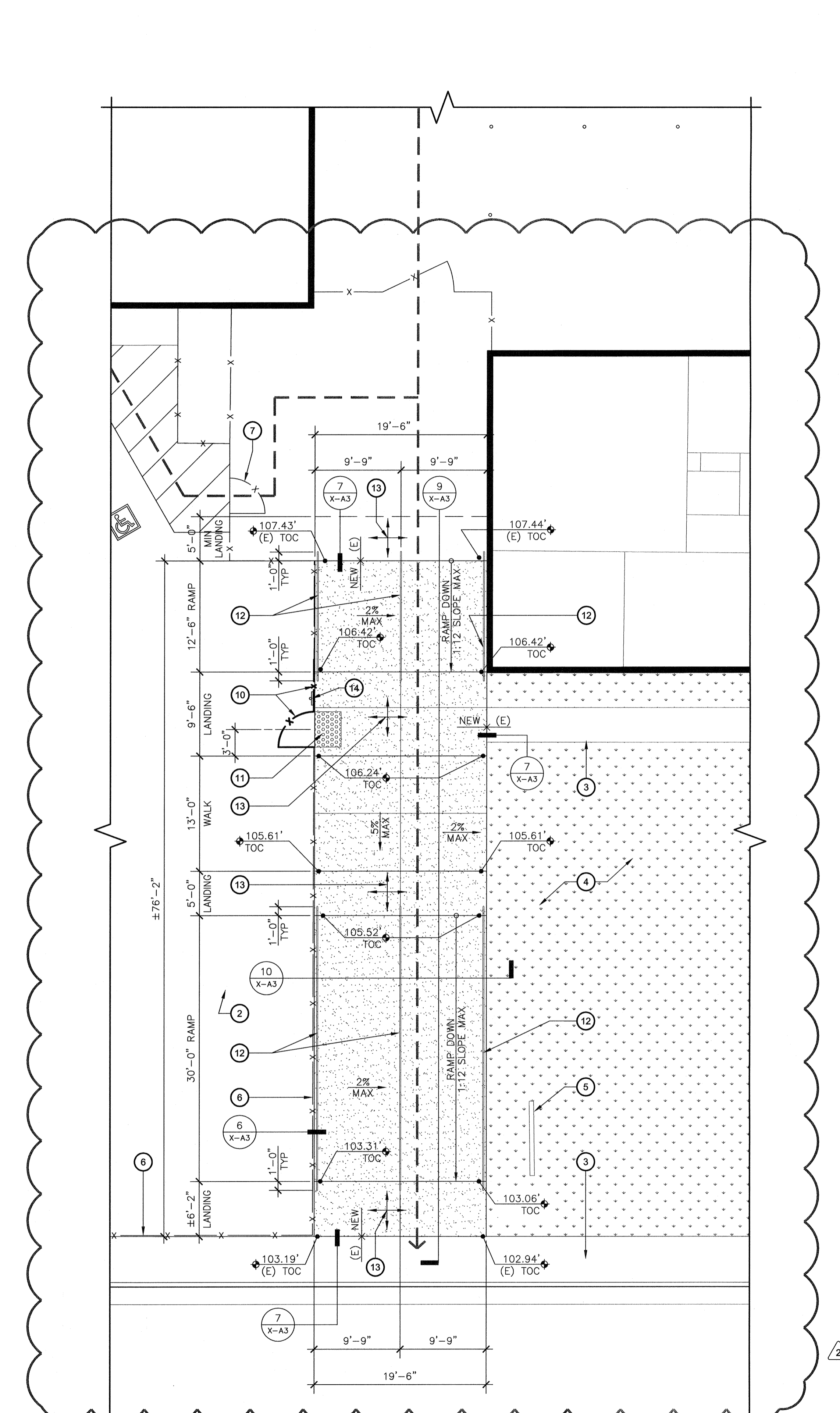

**ENLARGED SITE PLAN**

SCALE: 1/8" = 1'-0"



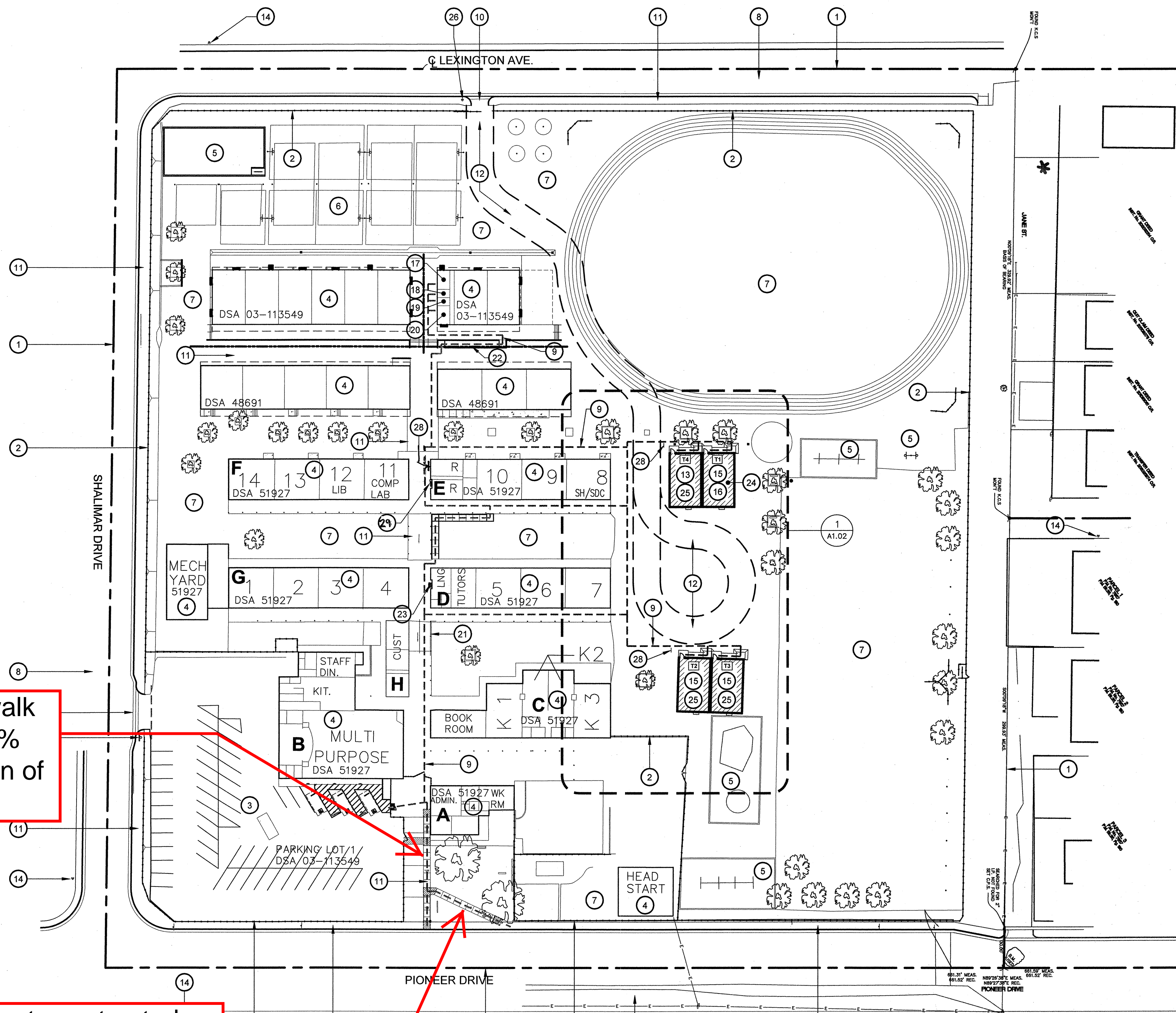
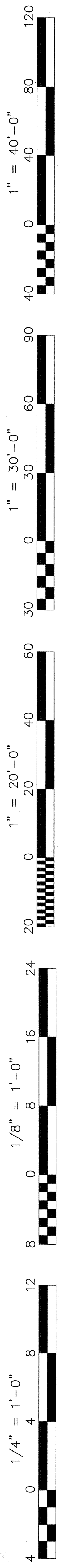

This concrete walk is too steep, >5% slope in direction of travel

This walk was not constructed because the grades are too steep. The resulting walk would not be compliant. This CCD provides an accessible path of travel to the public way.

**FOR REFERENCE ONLY**

**SITE PLAN**  
**4 RELOCATABLE CLASSROOMS**

SCALE: 1" = 50'

**KEYNOTES**

- PROPERTY LINE
- EXISTING CHAIN LINK FENCE TO REMAIN
- EXISTING PARKING LOT AND STRIPING TO REMAIN
- EXISTING BUILDING TO REMAIN (NO WORK)
- EXISTING PLAY AREA TO REMAIN (NO WORK)
- EXISTING A.C. PAVING TO REMAIN
- EXISTING LAWN / TURF TO REMAIN
- EXISTING PUBLIC ROADWAY TO REMAIN
- EXISTING CONCRETE WALK TO REMAIN
- PROPOSED 20' WIDE FIRE TRUCK ACCESS LANE
- NEW TEMPORARY CLASSROOM ON WOOD FOUNDATION W/ METAL RAMPS INSTALLED PER MANUFACTURERS DRAWINGS
- EXISTING FIRE HYDRANT TO REMAIN
- EXISTING NON-CONFORMING CLASSROOMS TO BE CONSIDERED CONFORMING PER THIS APPLICATION
- ROTATE EXISTING CLASSROOM 180° AND RESET FOUNDATION PER MANUFACTURERS DRAWINGS
- (E) ACCESSIBLE BOYS RESTROOM PER #03-113549
- (E) ACCESSIBLE MENS RESTROOM PER #03-113549
- (E) ACCESSIBLE WOMENS RESTROOM PER #03-113549
- (E) ACCESSIBLE GIRLS RESTROOM PER #03-113549
- EXISTING RAMP PER DSA APP #51927 w/ EXISTING HANDRAIL PER DSA APP #03-113549
- EXISTING ACCESSIBLE RAMP PER DSA APP #03-113549
- EXISTING DRINKING FOUNTAIN PER DSA APP #51927
- FOUNDATION PER STOCKPILE #04-100596
- NEW FOUNDATION PER PC #04-112161
- EXISTING HYDRANT PER DSA APP #03-113549
- EXISTING SITE ENTRANCE SIGN PER DSA APP #03-113549
- ACCESSIBLE RESTROOM DIRECTIONAL SIGNAGE MOUNTED AT +80" MIN. ABOVE FINISH GRADE. SEE DETAIL 6/A1.03
- NEW HI-LOW ACCESSIBLE DRINKING FOUNTAIN, SEE DETAIL 7/A1.03**

**PARKING LOT #1**

TOTAL STALLS PROVIDED:	52
ACCESSIBLE STALLS REQUIRED PER CBC TABLE 11B-6:	3
VAN SPACES REQUIRED (1 PER 8 ADA):	1
ACCESSIBLE STALLS PROVIDED:	2 REGULAR 1 VAN 3 TOTAL

**ACCESSIBILITY NOTES**

- ARCHITECT HAS INSPECTED THE PATH OF TRAVEL (P.O.T.) AS INDICATED ON THE PLANS AND HAS FOUND IT TO BE, OR HAS INDICATED ON THE PLANS REMEDIAL WORK WHICH WOULD CAUSE IT TO BE, A BARRIER-FREE ACCESSIBLE ROUTE:
- AT LEAST 48" IN WIDTH, OR AS APPROVED BY CODE
  - FREE OF ABRUPT LEVEL CHANGES EXCEEDING 3/4" IF BEVELED AT 1:2 MAX SLOPE, OR VERTICAL LEVEL CHANGES EXCEEDING 3/4"
  - WITH A FIRM, STABLE, AND SLIP RESISTANT WALKING SURFACE
  - WITH A RUNNING SLOPE OF 1:20 (5%) OR LESS AND WITH A CROSS SLOPE OF 1:50 (2%) OR LESS OR A RAMP WITH A RUNNING SLOPE OF 1:12 (8.33%) AND A CROSS SLOPE OF 1:50 (2%) WITH APPROPRIATE REQUIREMENTS AS DETAILED WITHIN THIS SET OF DOCUMENTS.
  - IS FREE OF OVERHEAD OBSTRUCTIONS WITHIN 80" ABOVE THE WALKING SURFACE
  - IS FREE OF OBJECTS WHICH PROTRUDE MORE THAN 4" BETWEEN THE HEIGHTS OF 27" AND 80" ABOVE THE WALKING SURFACE

**GENERAL NOTES**

- GENERAL CONTRACTOR SHALL FIELD VERIFY ALL SITE CONDITIONS PRIOR TO BID. IF ANY DISCREPANCIES ARE FOUND, THE ARCHITECT SHALL BE NOTIFIED IN WRITING.
- CONTRACTOR SHALL BE RESPONSIBLE FOR THE CORRECTNESS OF LAYOUTS AND ESTABLISHED LOCATIONS OF BURIED UTILITY LINES. ANY UTILITIES REQUIRING RELOCATION SHALL BE THE RESPONSIBILITY OF THE GENERAL CONTRACTOR CONTACT APPLICABLE GOVERNING AGENCIES REGARDING ARRANGEMENT AND COORDINATION OF WORK.
- GENERAL CONTRACTOR WILL BE RESPONSIBLE FOR ANY COMPACTION RETEST DUE TO INITIAL FAILURE.
- PROJECT INSPECTOR SHALL BE EMPLOYED BY THE OWNER, APPROVED BY THE RESPONSIBLE ARCHITECT AND DSA.
- A COPY OF TITLE-24, ALL PARTS APPLICABLE, TO BE KEPT AT THE JOB SITE AT ALL TIMES.
- ADDENDA SHALL BE SIGNED BY THE ARCHITECT (RESPONSIBLE IN CHARGE) AND APPROVED BY DSA.
- C.C.D.s SHALL BE SIGNED BY THE ARCHITECT (RESPONSIBLE IN CHARGE), OWNER AND APPROVED BY DSA.
- TESTING LAB SHALL BE EMPLOYED BY THE OWNER, APPROVED BY THE RESPONSIBLE ARCHITECT AND DSA.
- ALL WORK SURFACES DISTURBED OR DAMAGED BY THE CONSTRUCTION ACTIVITIES SHALL BE REPAIRED IN KIND, TEXTURED AND FINISHED TO MATCH ADJACENT SURFACES.
- NEW CONCRETE WALKS SHALL HAVE SLOPES NOT TO EXCEED 1 IN 20 IN THE DIRECTION OF PATH OF TRAVEL. PROVIDE CONTROL JOINTS (C.J.) AT 5'-0" o.c. MAX. AND EXPANSION JOINTS NOT TO EXCEED 30'-0" MAX. PROVIDE MEDIUM BROOM FINISH ON ALL WALKS.
- ALL BUILDING AND ROOM NAMES INDICATED ON THESE CONSTRUCTION DOCUMENTS ARE "NOT" THE ACTUAL BUILDING ROOM SIGNAGE DESIGNATION. THE GENERAL CONTRACTOR SHALL FURNISH, INSTALL AND COORDINATE ALL REQUIRED SIGNAGE WITH THE OWNER/ARCHITECT PRIOR TO STARTING CONSTRUCTION.
- GENERAL CONTRACTOR WILL BE RESPONSIBLE TO COORDINATE RELOCATABLE BUILDING DELIVERY DATES TO THE SCHOOL SITE WITH THE MFGR.
- THE GENERAL CONTRACTOR SHALL CONSTRUCT ALL NEW RELOCATABLE BUILDING FOUNDATIONS AS PER THE RELOCATABLE BUILDING MANUFACTURER'S DRAWINGS AND SPECIFICATIONS.
- THE GENERAL CONTRACTOR SHALL BE RESPONSIBLE TO PROVIDE ALL HOOK-UPS TO THE RELOCATABLE BUILDINGS AFTER INSTALLATION HAS BEEN COMPLETED BY THE MANUFACTURER.
- 5'-0" DEEP x 5'-0" WIDE MINIMUM LANDINGS AT DOORWAYS SHALL BE AS DETAILED AND SHALL HAVE SLOPES (IN ANY DIRECTION) OF NOT GREATER THAN 1/4 IN 12 SLOPE. SLOPES SHALL BE AWAY FROM DOORWAYS.
- GENERAL/SITE CONTRACTOR SHALL FIELD VERIFY THAT EXISTING PATH OF TRAVEL (P.O.T.) IS A MINIMUM OF 4'-0" WIDE AND IS SLIP RESISTANT. IF IT IS NOT, THEN THE CONTRACTOR SHALL NOTIFY THE ARCHITECT OF RECORD AND A REMEDY OR ALTERNATE P.O.T. WILL BE PROVIDED.
- THE MAXIMUM DROP BETWEEN EXISTING FINISHED GRADES AND THE TOP OF THE P.O.T. SHOULD NOT EXCEED 4". IF IT DOES, PROVIDE THE NECESSARY WARNING CURB PER CBC SEC. 11338.8.1.

**LOCAL FIRE AUTHORITY REVIEW**

LOCAL FIRE AUTHORITY REVIEW

AGENCY NAME: Bakersfield City Fire Department

ADDRESS: 6842 Victoria St

CITY/STATE: Bakersfield, CA

PHONE NUMBER: (805) 862-5007

DATE: 10/29/13

REVIEWED BY: [Signature]

APPROVED BY: [Signature]

**LEGEND**

- INDICATES EXISTING BUILDING TO REMAIN (NO WORK)
- INDICATES NEW TEMPORARY BUILDING UNDER THIS APPLICATION
- INDICATES FIRE TRUCK ACCESS OVER AC PAVING
- HALF-TONE DASHED LINE INDICATES ACCESSIBLE PATH OF TRAVEL

Ownership of Documents  
This document, the ideas and designs incorporated herein, as an instrument of Professional Service is the property of Integrated Designs by SOMAM, Inc. and is not to be used, in whole or in part for any other project without written authorization.  
© COPYRIGHT 2012

Integrated designs by SOMAM, Inc.  
ARCHITECTURE · ENGINEERING · INTERIOR DESIGN · CONSTRUCTION MANAGEMENT  
6011 N. Francis, Suite 130 - Fresno, California 93710  
Phone (559) 438-0861 Fax (559) 438-0867 E-Mail: design@somam.com  
www.integrateddesigns.com

Revision Description: \_\_\_\_\_  
Rev. Date: \_\_\_\_\_

**SITE PLAN**

Project Name & Address:  
**PIONEER ELEMENTARY**  
**4 RELOCATABLE CLASSROOMS**  
BAKERSFIELD CITY SCHOOL DISTRICT  
4404 PIONEER DRIVE BAKERSFIELD, CA 93306

Issue Date: \_\_\_\_\_  
Date: 10/29/13  
Designer: \_\_\_\_\_  
DR: \_\_\_\_\_  
PC: CJM

Agency Approval Stamp:

FILE # 15-6

IDENTIFICATION STAMP  
DIV. OF THE STATE ARCHITECT  
OFFICE OF REGULATION SERVICES

03-115335

DATE: JAN 08 2014

TRACKING #: 63321-131

Stamp(s):

Job No.: **5082**

Sheet No.: **A1.01**

Release: \_\_\_\_\_

Professional Engineer Seal: [Seal]