

ORDIZ MELBY ARCHITECTS, INC.
 5500 MING AVENUE SUITE 280
 BAKERSFIELD, CALIFORNIA 93309
 TELEPHONE (661) 832-5258
 FACSIMILE (661) 832-4291

SITE DEMOLITION LEGEND	
[Pattern]	EXISTING CONCRETE TO BE REMOVED
[Pattern]	EXISTING ASPHALT PAVING TO BE REMOVED
[Pattern]	EXISTING MODULAR CLASSROOMS TO BE REMOVED
[Pattern]	EXISTING BUILDING TO BE REMOVED
[Pattern]	TURF TO BE REMOVED
[Pattern]	PLAY EQUIPMENT AREA TO BE REMOVED

SITE LEGEND	
[Pattern]	CONCRETE WALK
[Pattern]	TURF
[Pattern]	EXISTING RESTROOMS (NO WORK IN THIS AREA)
[Pattern]	EXISTING CHAIN LINK FENCE
[Pattern]	EXISTING A.C. PAVING
[Pattern]	EXISTING CONCRETE CURB
[Pattern]	EXISTING PORTABLE CLASSROOM TO BE RELOCATED

SITE DEMOLITION KEYNOTES:

- 1. REMOVE (E) AC PAVING IN PARKING LOT
- 2. REMOVE (E) CONCRETE CURB
- 3. REMOVE (E) TURFLANDSCAPE. REMOVE (E) IRRIGATION LINES
- 4. REMOVE (E) TUBE STEEL BOLLARDS AND FOOTINGS IN THEIR ENTIRETY
- 5. REMOVE (E) COLD STORAGE BOX IN ITS ENTIRETY. REMOVE ASSOCIATED ELECTRICAL AND/OR PLUMBING LINES.
- 6. REMOVE (E) CONCRETE SLAB AND AC PAVING
- 7. REMOVE AND REPLACE (E) DOUBLE CHECK. SEE CIVIL DRAWINGS
- 8. REMOVE (E) C-TRAIN CONTAINERS
- 9. REMOVE (E) RAISED PLANTERS. REMOVE ASSOCIATED IRRIGATION LINES WITHIN RAISED PLANTER.
- 10. REMOVE (E) CONCRETE WALK, PATCH AND REPAIR (E) CONCRETE THAT CONNECTS TO NEW CONCRETE WALK.
- 11. REMOVE (E) CONCRETE STAIRS AND ASSOCIATED HANDRAILS IN THEIR ENTIRETY
- 12. REMOVE (E) PLAYGROUND EQUIPMENT AND ASSOCIATED FOOTINGS. REMOVE (E) WOOD CHIP MATERIAL. SCHOOL DISTRICT DECISION ON WHETHER TO SALVAGE AND STORE PLAYGROUND EQUIPMENT.
- 13. REMOVE (E) CONCRETE RAMP AND HANDRAILS IN THEIR ENTIRETY
- 14. REMOVE (E) BIKE RACKS, AC PAVING AND CHAIN LINK FENCE
- 15. REMOVE (E) TREE IN ITS ENTIRETY
- 16. REMOVE (E) TREE STUMP IN ITS ENTIRETY
- 17. REMOVE (E) UTILITY BOX COVER WITH A TRAFFIC RATED COVER. SET ELEVATION OF UTILITY BOX FLUSH WITH NEW AC PAVING/DRIVEWAY.
- 18. REMOVE (E) BUILT-UP AC PAVING
- 19. REMOVE (E) HOSE BIB. CAP WATER LINE BELOW NEW BUILDING SLAB.
- 20. REMOVE (E) COVERED WALK, TUBE STEEL POSTS, AND ASSOCIATED POST FOOTINGS.
- 21. REMOVE (E) CHAIN LINK FENCE AND ASSOCIATED POST FOOTINGS
- 22. REMOVE (E) PLAY EQUIPMENT AND "SOFT FALL" SYNTHETIC MATERIAL
- 23. REMOVE (E) STORAGE SHED
- 24. REMOVE (E) FABRIC, SHADE STRUCTURES AND ASSOCIATED FOOTINGS
- 25. (E) PICNIC TABLES TO BE RELOCATED. LOCATION TO BE DETERMINED BY SCHOOL DISTRICT.
- 26. REMOVE (E) CONCRETE LANDING, STAIRS, RAMPS AND PIPE HANDRAILS
- 27. REMOVE (E) CONCRETE BORDER
- 28. REMOVE (E) SAND

IDENTIFICATION STAMP
 DIVISION OF STATE ARCHITECT
 OFFICE OF REGULATION SERVICES
 APPL. 03-117598
 FILE # 15-6
 AC FLS SS CML
 DATE 2.5.2017

MODERNIZATION AT MARS VAORHIES ELEMENTARY SCHOOL
 6001 PIONEER DRIVE
 BAKERSFIELD, CA 93307
 FOR:

BAKERSFIELD CITY SCHOOL DISTRICT
 1300 BAKER STREET
 BAKERSFIELD CA 93305

PTN: 63321-186

MARK	DATE	DESCRIPTION
	11/01/16	DSA SUBMITTAL
△		
△		
△		
△		

JOB NUMBER: 2015-1663
 CAD DRAWING FILE: 1663 VOORHIES MOD-Site Plan - CD18.pln
 DRAWN BY:
 CHECKED BY:
 CHECK AND VERIFY ALL DIMENSIONS BEFORE PROCEEDING WITH THE WORK. REPORT DISCREPANCIES TO THE ARCHITECT.
 THE DRAWINGS, IDEAS, AND DESIGNS REPRESENTED ON THIS SHEET ARE THE PROPERTY OF THE ARCHITECT.
 COPYRIGHT: ORDIZ-MELBY ARCHITECTS, INC. 2014

SHEET TITLE
SITE PLAN DEMOLITION

SHEET IDENTIFICATION NUMBER
A-110

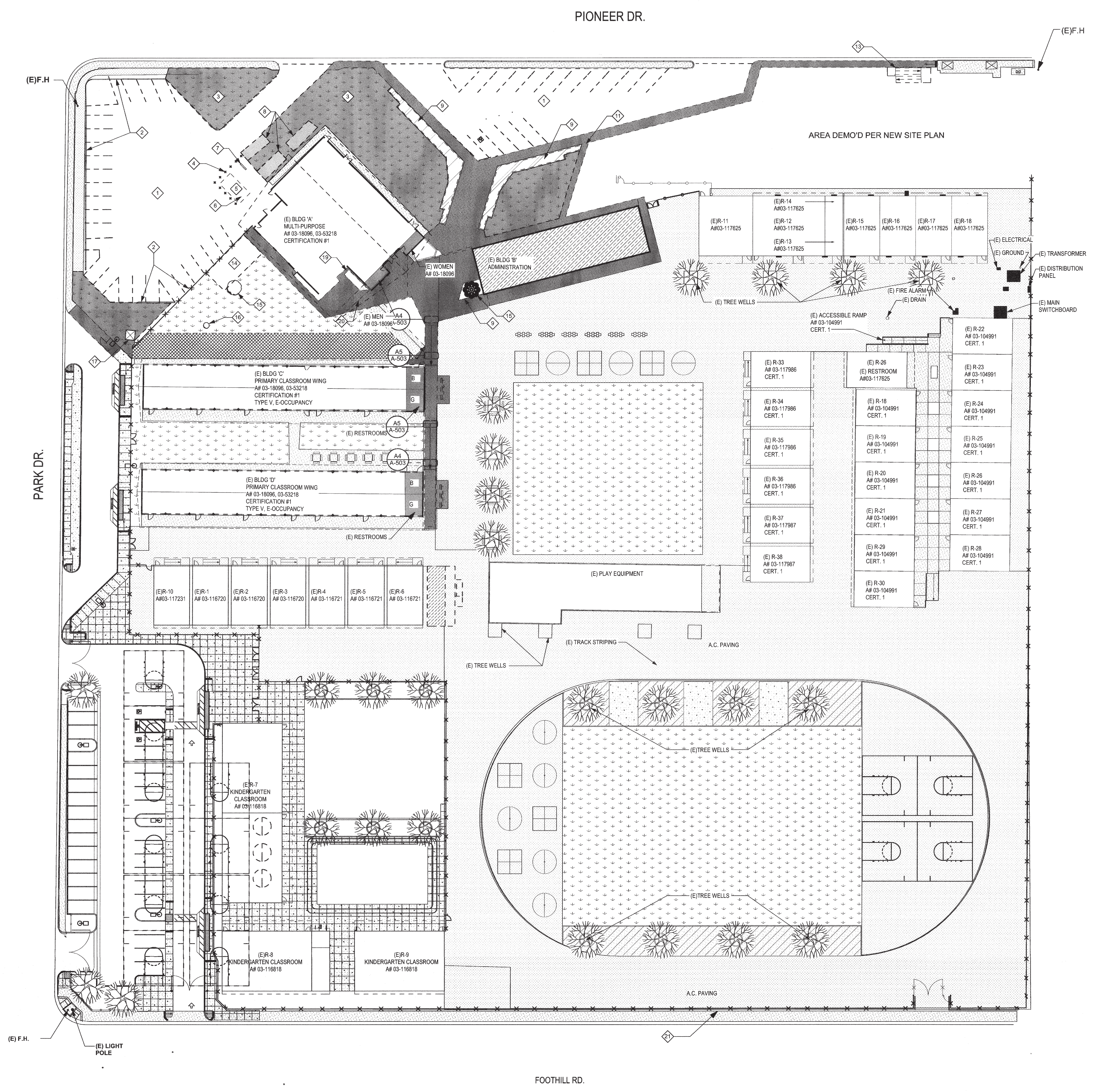

1 SITE PLAN DEMOLITION
 SCALE: 1" = 30'

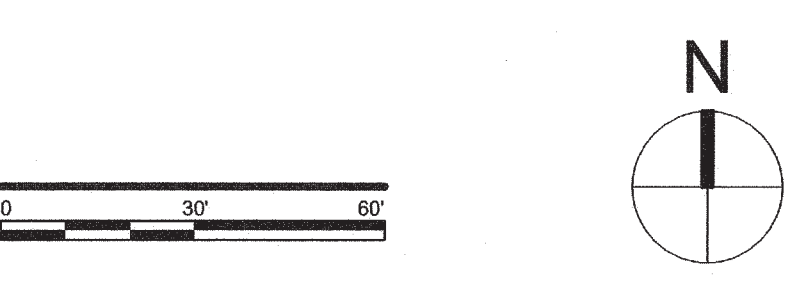

P:\DRAWING\2015\1720215\1663\Drawing\CD1863 VOORHIES MOD-Site Plan - CD18.pln
 PLOT DATE: 7/20/17