

24'x40' CROSS SECTION A-A

**GENERAL NOTES**  
 ALL DIMENSIONS UNLESS OTHERWISE NOTED  
 OWNER: 5, 6, 7, 8, AND 9

**NORMAN A. GEIGER**  
 AIA, CSI, CDT, ICBG  
 P.O. BOX 41064 95841  
 Sacramento, CA  
 (916) 352-2468 FAX  
 (916) 352-2468 PHONE



**ARCHITECTURAL SERVICES**

**LEGEND**  
 PARTITION  
 INSULATION  
 ROOF INSULATION (OPTIONAL)  
 WOOD SHEATHING  
 GYPSUM BOARD  
 SHEATHING  
 STUDS  
 RAFTERS

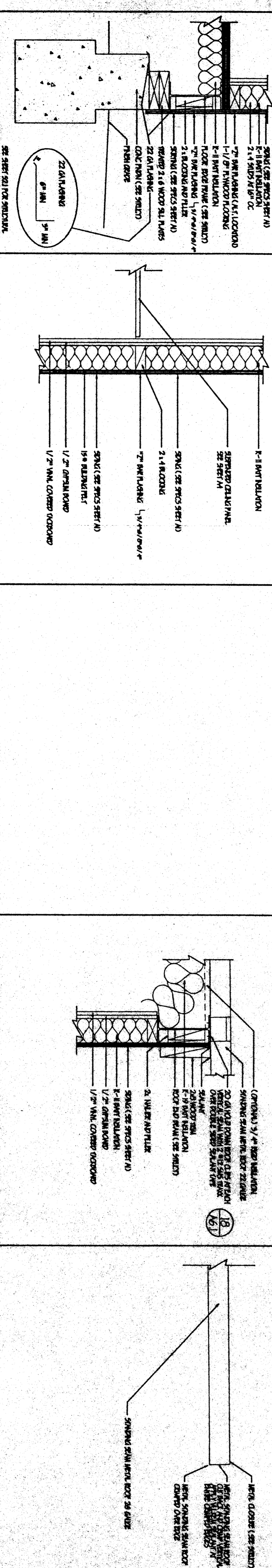

1	WOOD FNDN	SCALE: 1/2"=1'-0"
2	CONC FNDN	SCALE: 1/2"=1'-0"
3	FLOOR	SCALE: 1/2"=1'-0"
4	1 1/2" BAR FLASHING	SCALE: 1/2"=1'-0"
5	DETAIL	SCALE: 1/2"=1'-0"
6	DETAIL	SCALE: 1/2"=1'-0"
7	CORNER	SCALE: 1/2"=1'-0"
8	ENTRY SOFFIT OVERHANG	SCALE: 1/2"=1'-0"
9	MOD CONNECTION	SCALE: 1/2"=1'-0"
10	ENTRY SOFFIT OVERHANG	SCALE: 1/2"=1'-0"

**APPROVALS**

DESIGN/CONSTRUCTION STAMP  
 DIV. OF THE STATE ARCHITECT  
 DATE: 11/15/97  
 NO. 12345

PC 330  
 DATE: NOV 20 1997

**DATE CHANGES**

NO.	DATE	DESCRIPTION
REV. 01	MAR 20, 1997	
REV. 02	MAR 20, 1997	
REV. 03	MAR 20, 1997	
REV. 04	MAR 20, 1997	
REV. 05	MAR 20, 1997	

**DRAWING SCALE**  
 PROJECT NUMBER: 97-02  
 SHEET: A5.1

**PACESETTER INDUSTRIES, INC.**  
 P.O. BOX 1151, MODESTO, CA 95351 (209) 521-1800

**24x40 RELOCATABLE BUILDING**